

## Enclosed Isolator Switch IP53

Type: SW40 / 440



### Rated Operational Voltage, Ue

IEC/EN/VDE	Volts	V	690
UL/CSA	Volts	V	600
Main Switch: Isolating Voltage Upto	Volts	V	750
Resistance to Surge Pulse Voltage, Uimp	Volts	kV	6
Rated Uninterrupted Current, Iu	Amp	A	40

### Rated Operational Current, Ie

IEC/EN/VDE	AC22	Amp	A	40	
	AC-21A	IEC/EN/VDE	Amp	A	40
	AC-1	Amp	A	63	
UL/CSA		Amp	A	40	

### Rated Operational Power at 50 to

IEC/EN/VDE	AC-23A,	220-240V	kW	11
	3 PHASE, 3 POLE	380-440V	kW	18.5
		500-690V	kW	22
IEC/EN/VDE	AC-3,	220-240V	kW	7.5
	3 PHASE, 3 POLE	380-440V	kW	18.5
		500-690V	kW	18.5

### Short Circuit Capacity (IEC/EN/VDE)

Max. Fuse Size (Type gL)	Amp	A	40
Rated fused short circuit current	Amp	kA	30

DOL

3 PHASE, 3 POLE	120V	HP	5
	240V	HP	10
	480V	HP	20
1 PHASE	600V	HP	30
	120V	HP	3
	240V	HP	4

### Short Circuit Capacity (UL/CSA)

Max. Fuse Size	Amp	A	70
Fuse Rating, J Type	Amp	A	70
Rated Fused Short Circuit Current	Amp	kA	10

### Terminal Cross Section

Single/Multiple Strand Wire	Min-mm <sup>2</sup>	4
	Max-mm <sup>2</sup>	16
Fine-Strand Wire with Sleeve	Min-mm <sup>2</sup>	2.5
	Max-mm <sup>2</sup>	10
American Wire Gauge	-	AWG 6
Recommended Tightening Torque	-	Nm 1.7

32A - 63A

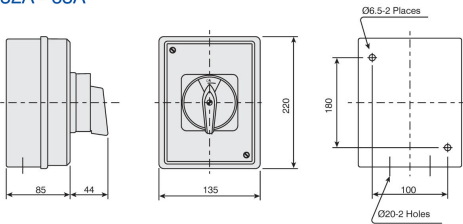

Caution : Open the cover only in 'OFF' position



Dokument/document		Utgava datum/edition date
Försäkran om överensstämmelse/ Declaration of conformity		29/06/2016
Avdelning/department Kvalite/Quality		
Ansvarig/prepared Magnus Arvidsson	Version 5	Sida/page 1 av/of 1

Supplier/Tillverkare: **GAROAB**  
Box 203  
S-335 25 GNOSJO Telephone: +46 (0)370 33 28 00  
Sweden Telefax: +46 (0)370 33 28 50

Supplier established within EU/Ombud etablerad inom EG

Supplier of equipment /Materielslag : Enclosed Isolator Switch IP53

Trade Mark/ Varumärke: GARO

Type Designation / Typbeteckning: SW3/4 20, 25, 32, 40, 63 ,80, 100, 125.

We hereby declare that our product fulfils the requirements of following EC directives/  
Vi intygar härmed att vår produkt uppfyller krav enligt följande EU direktiv:

- The Low Voltage Directive (LVD) 2014/35/EU / Lågspänningsdirektivet (LVD) 2014/35/EU.
- Electromagnetic compatibility (EMC) 2004/108/EU / Elektromagnetisk kompatibilitet (EMC) 2004/ 108/EG.
- RoHS Directive (RoHS) 2011/65/EU / RoHS direktivet (RoHS) 2011/65/EG.
- No electromagnetic compatibility (EMC) immunity or emission tests are required on the assembly/  
Produkten innehåller inte elektroniska apparater som påverkas enligt förbehållen enligt direktivet  
(EMC) 2004/108/EG.

The following harmonised standards (latest edition) or technical specifications which comply with good engineering practice in safety matters in force within the EU have been used in the design:/

Följande harmoniserade standarder (senaste utgåva) eller tekniska specifikationer som uppfyller god säkerhetsteknik praxis inom EG har använts i konstruktionen: EN 62; 69-1.'GP '82; 69/5

- The equipment conforms completely with the above stated harmonised standards or technical specifications./  
Materielen överensstämmer helt med ovan angivna harmoniserade standarder eller tekniska specifikationer.

Or/eller

- The equipment confirms only partially with the above stated harmonised standards or technical specifications but complies with good practice in safety matters in force within the EU./  
Materielen överensstämmer endast delvis med ovan angivna harmoniserade standarder eller tekniska specifikationer, men uppfyller god säkerhetsteknik praxis inom EG.

We have product surveillance according to CENELEC's harmonised requirements, documents CCA-201.

Garo AB  
Company/Företag

2016-06-29  
Date/Datum

Sign/Underskrift

Environmental- and Quality Manager/Kvalitets- och Miljöchef  
Position/Befattning

Magnus Arvidsson  
Name / Namnförtydligande